

# CORNER TRANSFER CONVEYOR



**Westmill™ can supply multiple designs of its single or double-level Corner Transfers, based on your requirements.**

**Westmill's Corner Transfer Belt Conveyor improves sheet presentation to your Dry Stacker, or allows you to install a Dry-Chain/Belt for pulling veneer into carts.**

Our Double-level Corner Transfers are available for high-production Dryer lines to ensure your Corner Transfer is not a bottleneck in your system.

Westmill™ can supply multiple designs based on your Dryer Outfeed's requirements or mill preference, including:

- *Pivoting Drop Pans with fixed Z-plate backstop*
- *Pivoting Drop Pans with pneumatic squaring backstop*
- *Camel-back 81X chain (steel or plastic welded attachments) with fixed Z-plate backstop*
- *Fixed rolls with jump belts*

Also available is an optional Reject Tipple (see image below), useful for diverting split sheets to a waste cart to prevent broken sheets from jamming up your Dry Stacker.

*If you can't see it in a Westmill™ brochure, please ask! Westmill™ was founded on machinery rebuilding and providing custom solutions, and it continues to be a core part of our business.*



**Pivoting Drop Pans with fixed Z-plate backstop**



**Pivoting Drop Pans with pneumatic squaring backstop**



**Fixed rolls with jump belts**



**Reject Tipple (shown at right of picture)**

## Product Features and Operation

Veneer is shot from the Multibelt/Incline Conveyor to the Corner Transfer Conveyor. With the drop pans in the up position, veneer skids along the tops of the pans and strikes the backstop. If a moving backstop is used, the backstop aligns the edges of the veneer sheets so that they are aligned for their approach to the Dry Chain or Dry Stacker.

After contact with the backstop, the drop pans pivot to the down position. The veneer is quickly lowered onto the continuously running rough-top belts, which carry the veneer away to the next conveyor or machine in the system.

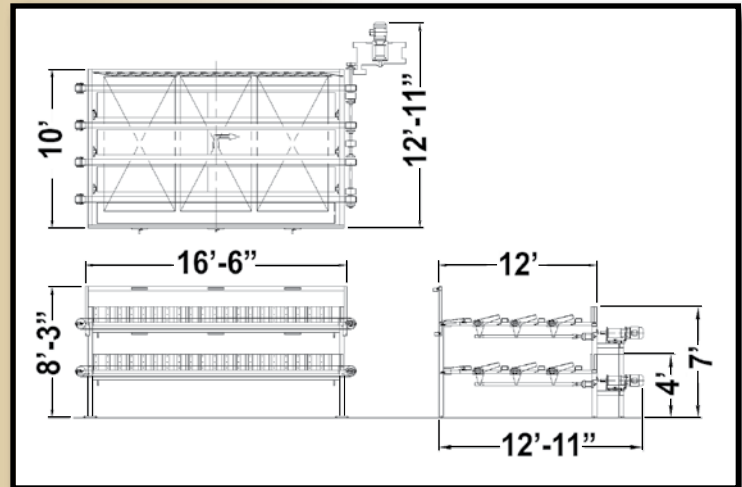

### Westmill's supply includes:

- Main frame with four belts per level of Corner Transfer
- Drive pulleys mounted to head shaft, and idler pulleys with bearings and screw take-ups
- 5 HP motor with reducer and Variable Frequency Drive (VFD) per level
- Polychain-toothed drive belt system, complete with guard
- Pneumatic cylinders for drop pans and backstop (if applicable)
- All pneumatic cylinders, valves, and pneumatic lines to one main customer hook-up
- Filter/Regulator/Lubricator unit
- Three photo eyes per level for "sheet-present" detection (for deck pan control)
- Wiring of valves and photo eyes to electrical junction box

## Veneer Specifications

Veneer size:	8' length veneer x any clip width (full sheets to randoms) Alternate designs available for 4' long veneer
Veneer species:	Any
Veneer moisture content:	Any (intended for Dry veneer conveying)

## Machinery Specifications

Electrical requirements:	Belt Drive: 5 HP (3 Phase) per each level of Corner Transfer
Field mounting:	Anchored to plant floor. Machinery feet have mounting holes.
Air requirements:	60 PSI

## Other Westmill™ Machines to Improve Dryer Unloading and Material Handling

- Dryer Sequential Unloader – Unloads your Dryer in an orderly fashion and presents veneer squarely to the Multibelt/Incline Conveyor. Available in any number of decks for any type of Dryer.
- Multibelt Conveyor – Takes veneer from Sequential Unloader to the Corner Transfer Conveyor.

